

REDUCED!

FOR LEASE/SALE

2,480 +/- Sq. Ft.
Office / Warehouse

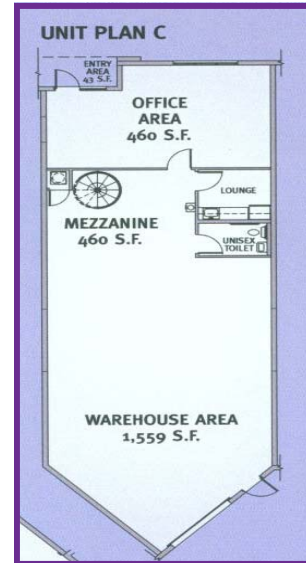

LOCATED WITHIN DOLPHIN PARK OF COMMERCE

2051 NW 112 Avenue, Unit #127, Miami FL

- 2,480 +/- Sq. Ft. Total
- 460 +/- Sq. Ft. of Office
- 460 +/- Sq. Ft. of Habitable Mezzanine Space
- Includes finished lounge/kitchenette
- Contemporary Architecture
- 1 Street Level Door
- Twin "T" Roof
- Sprinklered and Alarmed
- High Impact/Hurricane Resistant Glass
- 18' Ceiling Height
- 3 Parking Spaces

Lease Amount: \$3,500/Month plus tax

Sale Price: \$685,000



Offered Exclusively By:



Reshma Parvani

Cell: (305) 342-9576

Office: (305) 477-2084

Email: rparvani@parvanigroup.com

Sanjeet Parvani

Cell: (305) 772-5721

Office: (305) 477-2084

Email: sparvani@parvanigroup.com

10850 NW 21 St, Suite 110 Doral, FL. 33122

www.parvanigroup.com

Note: This offering subject to errors, omissions, prior sale or withdrawal without notice